



AIRPORT BUSINESS CENTER II / FOR LEASE

3500 S MACARTHUR BLVD., SUITE B, OKLAHOMA CITY, OK

BRETT PRICE, CCIM, SIOR
bprice@newmarkrp.com
C: 405.613.8380

KRIS DAVIS, SIOR
kgdavis@newmarkrp.com
C: 405.202.9525

KARLEY HARPER, CCIM
kharper@newmarkrp.com
C: 405.371.3498

NEWMARK
ROBINSON PARK

WAREHOUSE SPACE / FOR LEASE

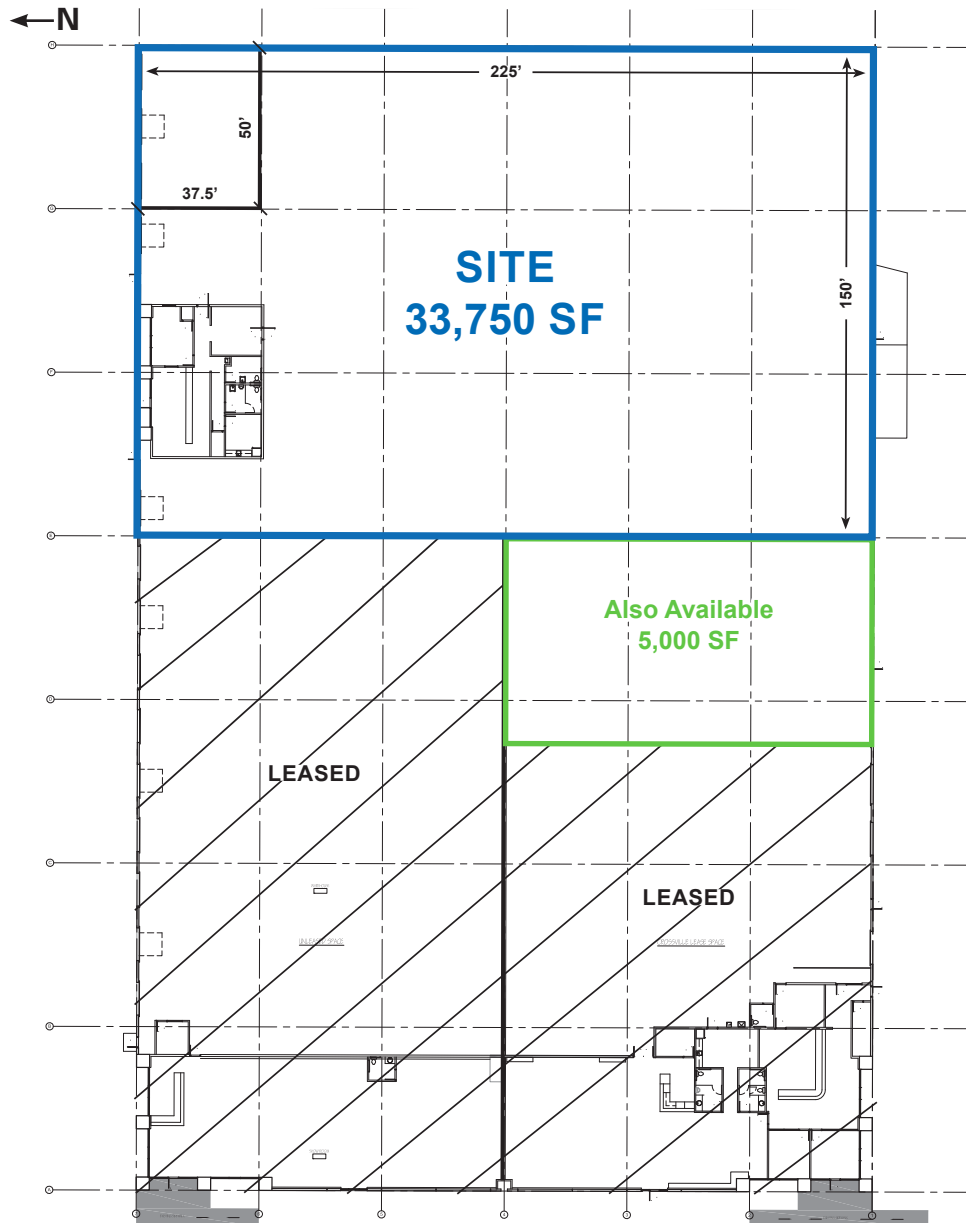

PROPERTY OVERVIEW

Airport Business Center II is less than 1/2 mile north of Hwy 152, approximately 2 miles from I-40 & I-44, and 2.5 miles north of Will Rogers World Airport. There is an additional 5,000 SF space in the building available for sublease.

DETAILS

Available SF	33,750 SF
Lease Rate	Contact Broker
Building Size	78,750 SF
Office Size	1,875 SF
Column Spacing	50' x 37.5'
Clear Height	28'
Doors	3 dock high doors, 2 with pit levelers 3 grade level doors
Parking	30 car parks
Zoning	I-3, Heavy Industrial

