

3465 Allan Industrial Dr.

3675 Allan Industrial Dr.

# WAREHOUSE/OFFICE BUILDINGS | FOR LEASE

3465 & 3675 ALLAN INDUSTRIAL DR., EL RENO, OK

**KRIS DAVIS, SIOR**  
kgdavis@newmarkrp.com  
C: 405.202.9525

**BRETT PRICE, CCIM, SIOR**  
bprice@newmarkrp.com  
C: 405.613.8380

**KARLEY HARPER, CCIM**  
kharper@newmarkrp.com  
C: 405.371.3498

**NEWMARK**  
ROBINSON PARK



# INDUSTRIAL PROPERTIES / FOR LEASE

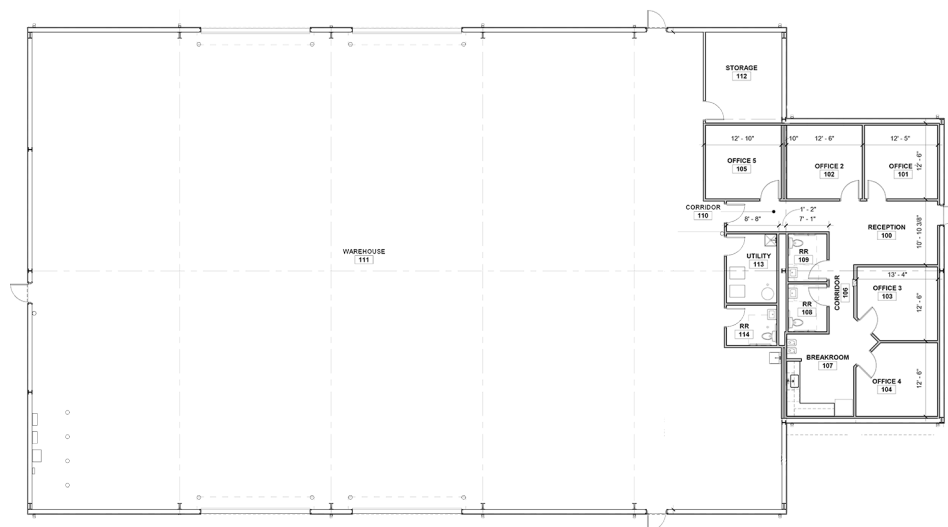

FLOOR PLAN

## DETAILS

Available SF	10,817 SF
Lease Rate	\$15,000/MO (NNN)
Building Size	10,817 SF
Lot Size	8 Acres Total
Submarket	El Reno
Cross Streets	Hwy 66 & N Banner Rd.

## HIGHLIGHTS

9,135 SF warehouse/storage space
1,682 SF office space
(4) 18' x 18' overhead doors
28' clear height
5 offices, reception area, and break room
Fenced and graveled yard

## PROPERTY OVERVIEW

New warehouse/office buildings under construction in the growing industrial corridor of Banner Rd. and I-40. They feature frontage along Hwy 66 and are approximately 1 mile north of I-40.

There are 2 separate buildings available, each 10,817 SF on 4 acre lots.