



8711

SOUTHEAST
COMMERCE PARK
BLUE ROAD INVESTMENTS

SE COMMERCE PARK | FOR LEASE

8711 POLE RD., OKLAHOMA CITY, OK

BRETT PRICE, CCIM, SIOR
bprice@newmarkrp.com
C: 405.613.8380

KRIS DAVIS, SIOR
kgdavis@newmarkrp.com
C: 405.202.9525

KARLEY HARPER, CCIM
kharper@newmarkrp.com
C: 405.371.3498



BLUE ROAD INVESTMENTS

NEWMARK
ROBINSON PARK

CLASS A REAR-LOAD BUILDING / FOR LEASE

DETAILS

Available SF	146,270 SF±
Divisible SF	89,463 SF & 57,807 SF
Lease Rate	Contact Broker
Building Size	146,270 SF±
Clear Height	32'
Year Built	2022
Zoning	I-3
Cross Streets	SE 89th & Pole Rd.

HIGHLIGHTS

Rear-load, 180' truck court
28 dock doors | 2 drive-in doors
(5) 35K lb pit levelers
54' x 55' column spacing with 60' speed bay
36 trailer parks | 133 car parks
2,000 SF office space

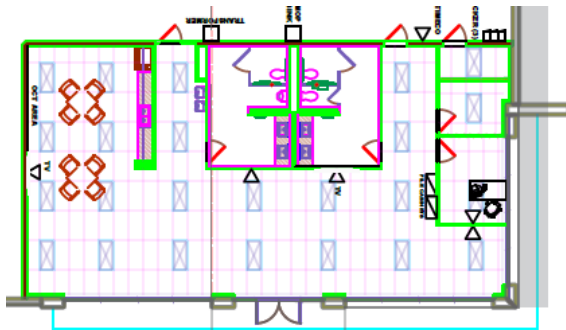

Office Floor Plan

PROPERTY OVERVIEW

Southeast Commerce Park is a master planned industrial park with 3 buildings totaling 403,791 square feet. It is located 1/2 mile east of I-35 and 1 mile south of I-240, which connects southeast Oklahoma City to Will Rogers World Airport. The development is within a 10 minute drive time to Tinker Air Force Base, Will Rogers International Airport, and Downtown Oklahoma City. Tenants in the transportation and logistics industries are well-served in this submarket by the Fed Ex Freight facility as well as one of BNSF's four logistics centers throughout the country.



204 N. Robinson, Ste 700 OKC, OK, 73102 | for more information, visit us at
110 W. 7th, Ste 2600 Tulsa, OK, 74119 | **NEWMARKRP.COM**

The information contained herein was obtained from sources believed reliable; however, Newmark Robinson Park makes no guarantees, warranties or representations as to the completeness or accuracy thereof. The presentation of this property is submitted subject to errors, omissions, change of price or conditions prior to sale or lease, or withdrawal without notice. Independently Owned and Operated.